

Adjustable up&down light distribution(5 positions)							
Size	Total Watt	Up	Up Watt	Up Lumen Output	Down	Down Watt	Down Lumen Output
2FT	25W	0%	0W	0	100%	25W	3500lm
		30%	7W	980lm	70%	18W	2520lm
		50%	12.5W	1750lm	50%	12.5W	1750lm
		70%	18W	2520lm	30%	7W	980lm
		100%	25W	3500lm	0%	0W	0
3FT	35W	0%	0W	0	100%	35W	4900lm
		30%	10.5W	1470lm	70%	24.5W	3430lm
		50%	17.5W	2450lm	50%	17.5W	2450lm
		70%	24.5W	3430lm	30%	10.5W	1470lm
		100%	35W	4900lm	0%	0W	0
4FT	50W	0%	0W	0	100%	50W	7000lm
		30%	15W	2100lm	70%	35W	4900lm
		50%	25W	3500lm	50%	25W	3500lm
		70%	35W	4900lm	30%	15W	2100lm
		100%	50W	7000lm	0%	0W	0
8FT	100W	0%	0W	0	100%	100W	14000lm
		30%	30W	4200lm	70%	70W	9800lm
		50%	50W	7000lm	50%	50W	7000lm
		70%	70W	9800lm	30%	30W	4200lm
		100%	100W	14000lm	0%	0W	0

NOTE:

1. Read instructions carefully before installation.
2. Install by a qualified electrician.
3. Make sure the power is OFF before starting installation or attempting any maintenance.
4. Application space is with no chemical compositions such as sulphur, acid, halogen etc.

Wiring

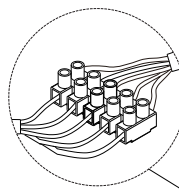

- Black: AC-L
- White: AC-N
- Yellow/Green: Grounding
- Purple: Dim +
- Pink: Dim-

★ Please leave the purple/pink wires alone if don't need dimming function.

DIP Switches Guide

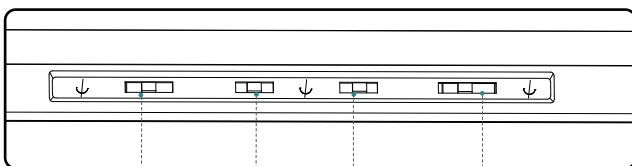

CCT Selectable

30K/35K/40K/50K/57K(preset at 50K)
35K/40K/50K(preset at 50K)

Watt Selectable

2FT: 25W 20W 15W 10W(preset at 25W)
3FT: 35W 30W 25W 20W(preset at 35W)
4FT: 50W 45W 40W 35W(preset at 50W)
8FT: 100W 90W 75W 60W(preset at 100W)

Up&Down Light Distribution

- ① Up: 100% & Down: 0%
- ② Up: 70% & Down: 30%
- ③ Up: 50% & Down: 50%
- ④ Up: 30% & Down: 70% (preset)
- ⑤ Up: 0% & Down: 100%

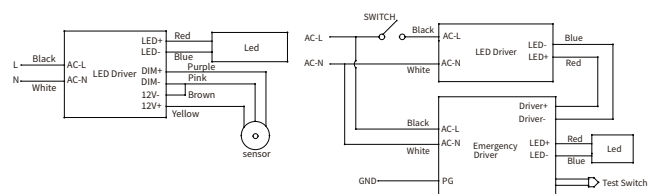

With Sensor

With EM Back-up

Surface Mount

STEP 1 Open the accessory package, take out the accessories as follows:

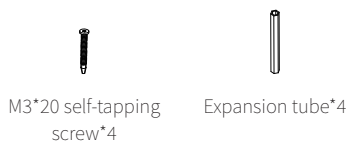

STEP 2 Take out the fixture, remove the two end caps.

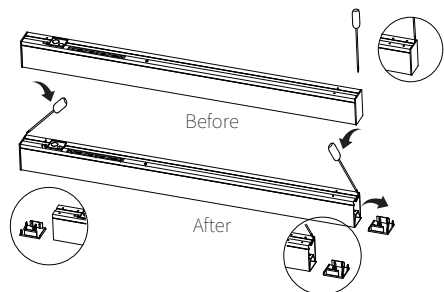

STEP 3 Put the fixture face up, and pull out the PC cover.

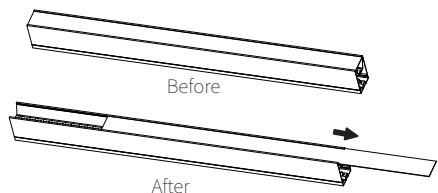

STEP 4 Unscrew the two screws on the LED module, then unplug the quick connectors between PCB and LED driver.

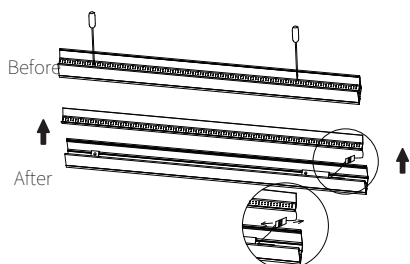

STEP 5 Drill holes on the ceiling according to the corresponding holes on the back of the fixture.

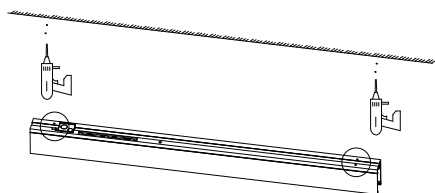

STEP 6 Drill expansion tubes into the corresponding holes.



STEP 7 Open the back lit cover on the fixture by unscrew the screw, take out the AC power cord and make wiring connection, Black=Line, White=Neutral, Yellow/Green=G, Purple=Dim+, Pink=Dim-. Then lock the back lit cover with screw.

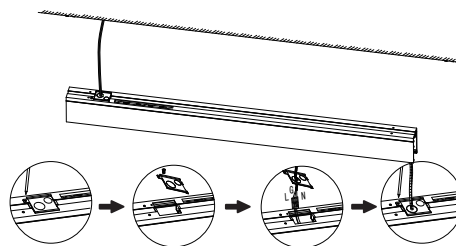

STEP 8 Use 4 screws (provided) to fix the fixture on the ceiling.

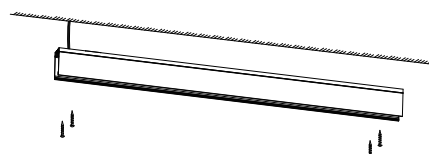

STEP 9 After the fixture is fixed, follow the steps in sequence, screw the LED module to the housing, connect the fast connectors between the PCB and LED driver, then slide the PC cover into the housing.

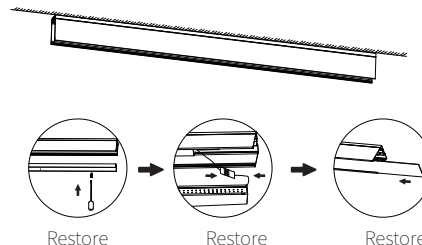

STEP 10 Assemble the end caps, align the buckle position, slightly push forward till it locked into the fixture.

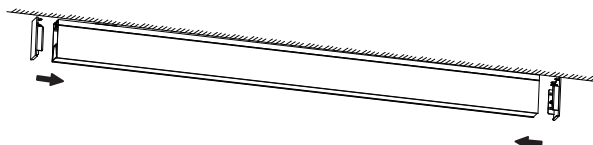

STEP 11 Turn on the electricity to verify your successful installation.

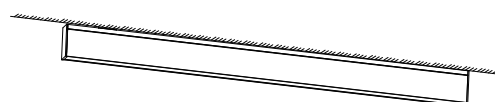

Wall Mount

STEP 1 Open the accessory package, take out the accessories as follows

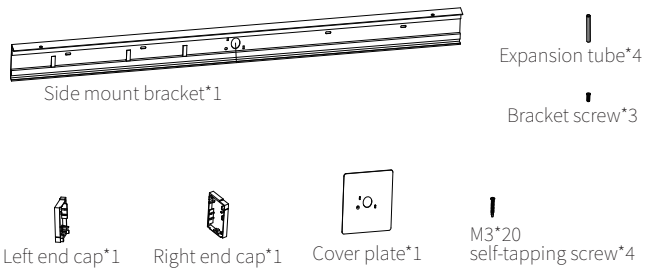

STEP 2 Take out the fixture, and use a flat-head screwdriver (not provided) to pry off the two end caps.

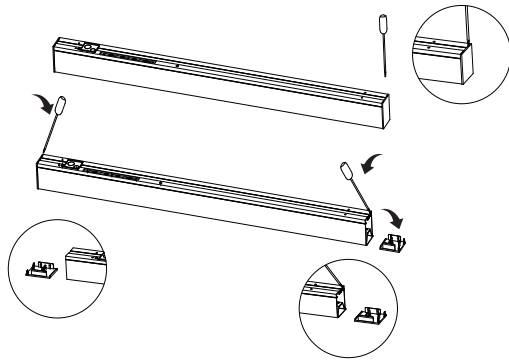

STEP 3 Drill holes on the wall according to the hole position of the mount bracket.

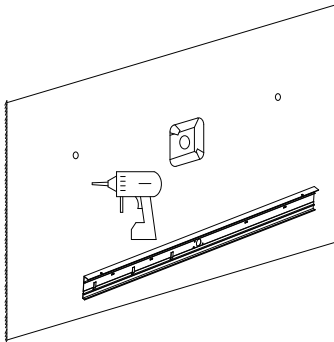

STEP 4 Fix the cover plate to the bracket by 3 screws (provided).

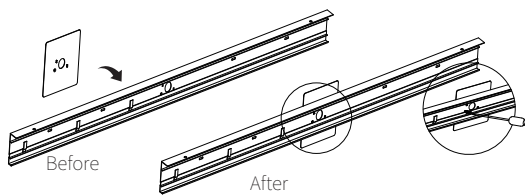

STEP 5 Feed the power cord through the cover plate from the junction box (not provided).

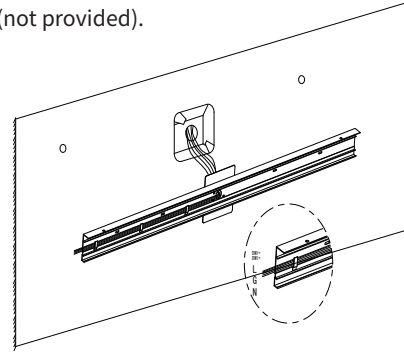

STEP 6 Use screws (provided) to fix the bracket to the wall firmly.

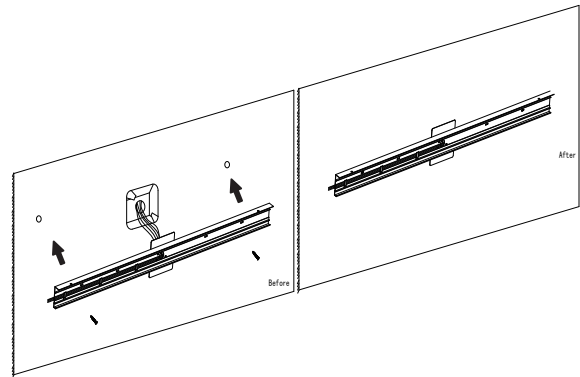

STEP 7 Use screws (provided) to fix the fixture to the bracket.

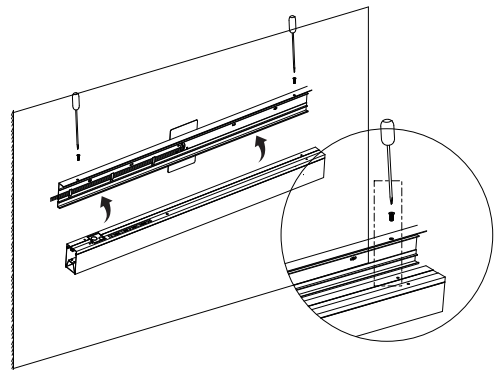

STEP 8 Wiring connection, insert the wires into existing wiring connector of the fixture. Black=Line, White=Neutral, Yellow/Green=G, Purple=Dim+, Pink=Dim-.

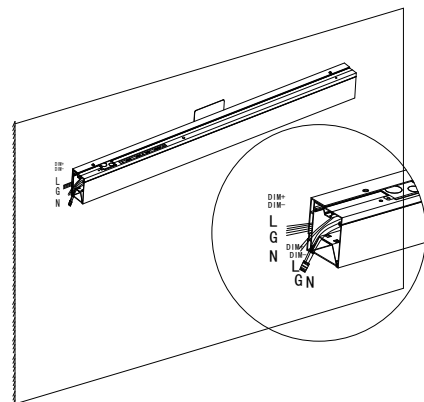

STEP 9 Take out the new end caps from the accessory bag, fix them firmly to the fixture according to the left and right directions.

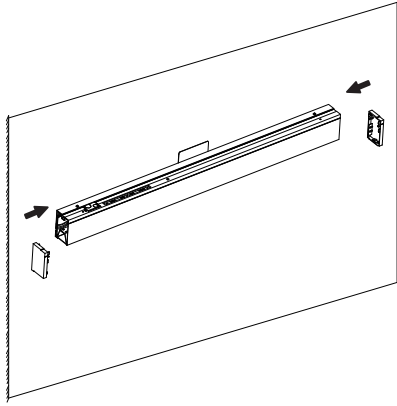

STEP 10 Turn on the electricity to verify your successful installation.

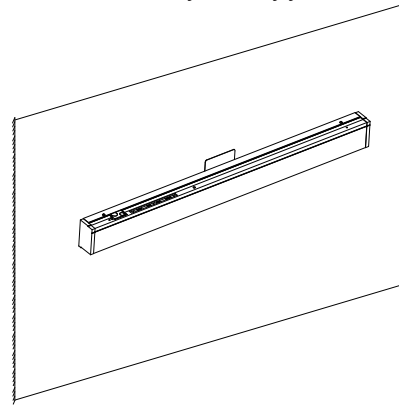

Frame Recessed Mount

STEP 1 Open the accessory package, take out the accessories as follows:

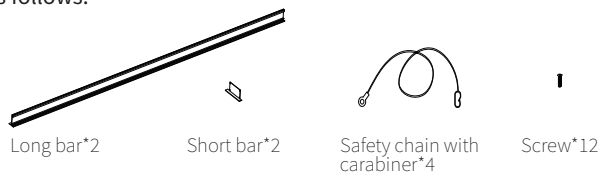

STEP 2 Assemble the long bar and short bar with the screws (provided).

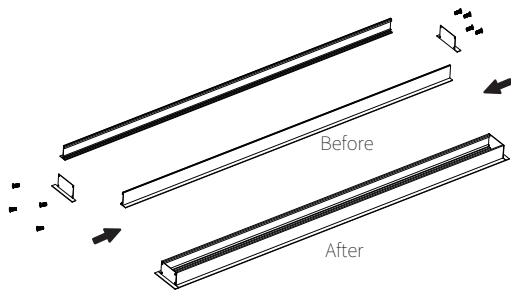

STEP 3 Use screws (provided) to fix the safety chain to the sides of the long bars.

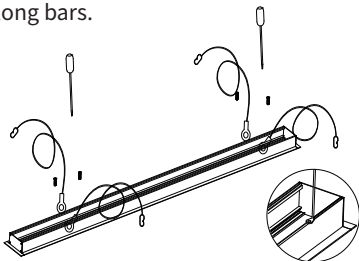

STEP 4 Put the fixture into the ready-frame.

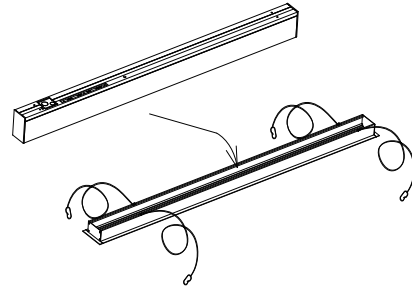

STEP 5 Drill holes in the plasterboard according to the requirements, fix the frame on the ceiling through the plasterboard, and adjust the height.

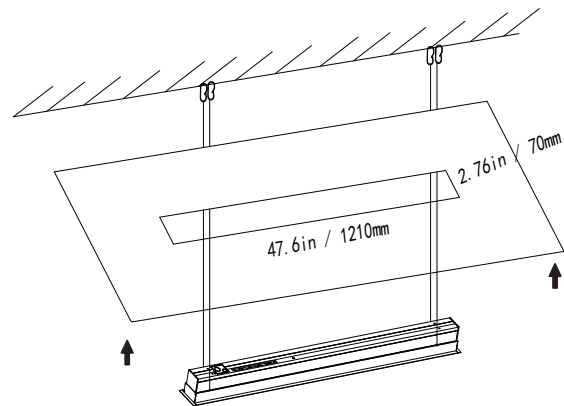

STEP 6 Turn on the electricity to verify your successful installation.

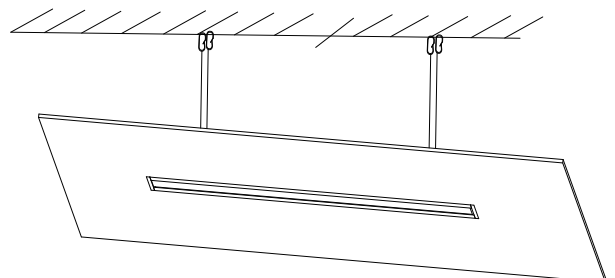

Frameless Recessed Mount

STEP 1 Open the accessory package, take out the accessories as follows, the threaded rod and two disc nuts have been installed on the tube clamp in the factory.

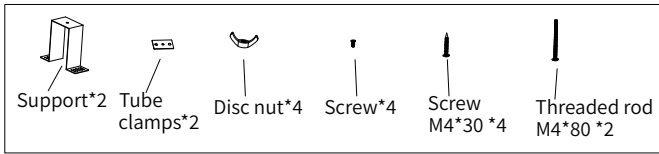

STEP 2 Fix the two assembled tube clamps (provided) to the back of the fixture.

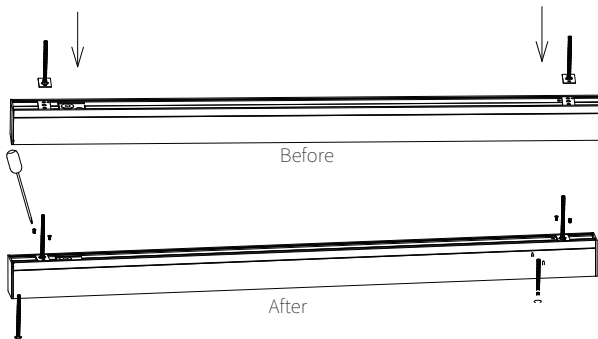

STEP 3 Screw the two support brackets (provided) into the threaded rod.

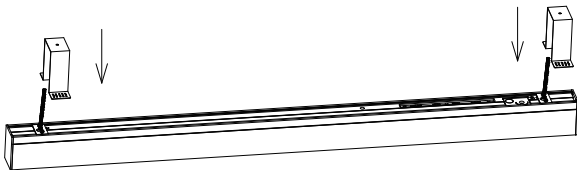

STEP 4 Adjust the height of the fixture to keep it on the same level, then tighten the disc nuts.

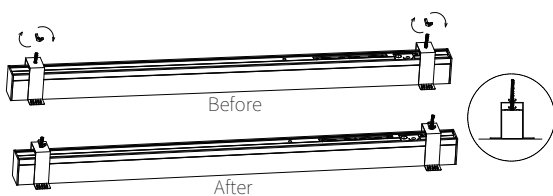

STEP 5 Put the fixture into the ceiling.

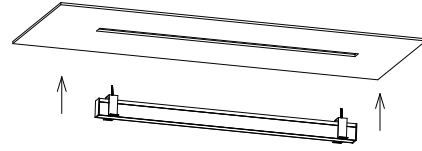

STEP 6 Use M4*30 screws (provided) to fix the support brackets on the ceiling.

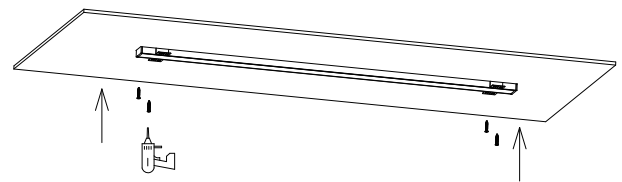

STEP 7 Paint around the brackets to match the ceiling.

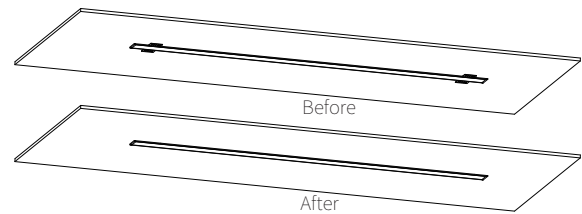

STEP 8 Turn on the electricity to verify your successful installation.

Suspension Mount

STEP 1 Open the accessory package, take out the accessories as follows:

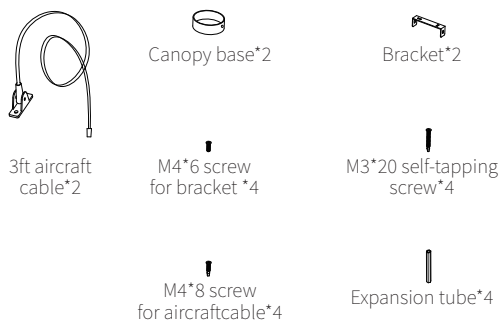

STEP 2 Take out the canopy base, feed the aircraft cable in and fix it.

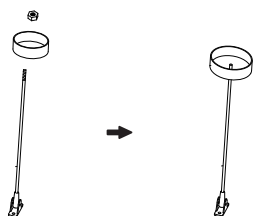

STEP 3 Use screws (provided) to fix the suspension cable to the fixture.

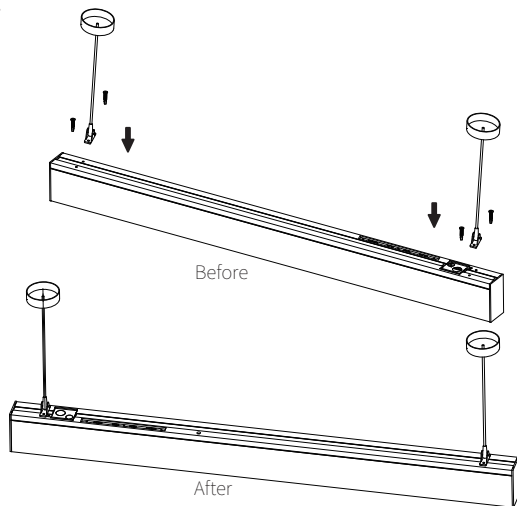

STEP 4 Use screws (provided) to fix the brackets on the ceiling.

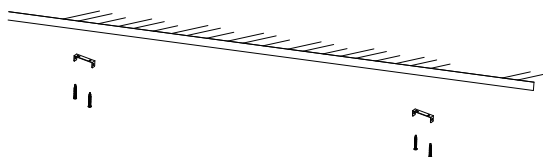

STEP 5 Use screws (provided) to fix the canopy kit to the bracket.

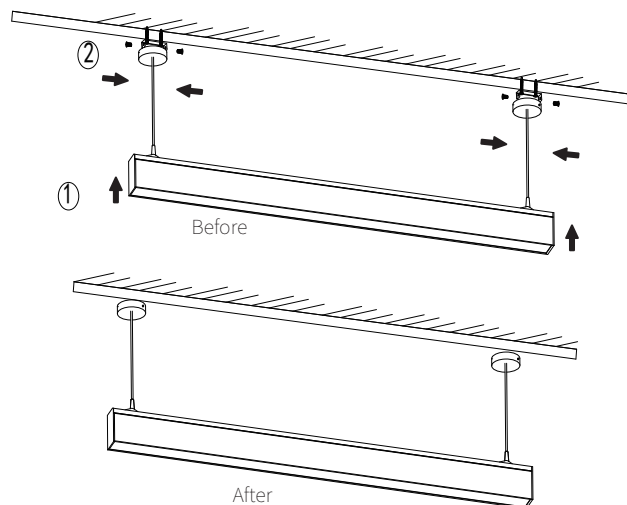

STEP 6 Open the back lit cover on the fixture by unscrew the screw, take out the AC power cord and make wiring connection, Black=Line, White=Neutral, Yellow/Green=G, Purple=Dim+, Pink=Dim-. Then lock the back lit cover with screw.

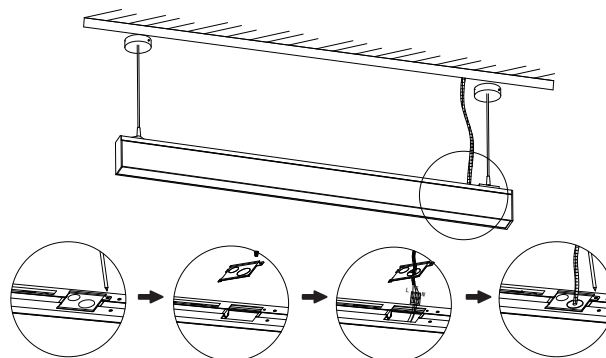

STEP 7 Turn on the electricity to verify your successful installation.

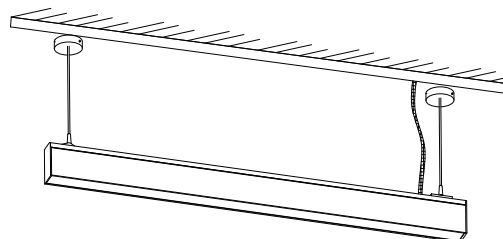

Series Connection

STEP 1 Open the accessory package, take out the accessories as follows:



H Mounting plate



Linkable Connector



M4*8 screw *4

STEP 2 Remove the left end cover of one fixture, then remove the right end cover of another fixture which need to be joined together.

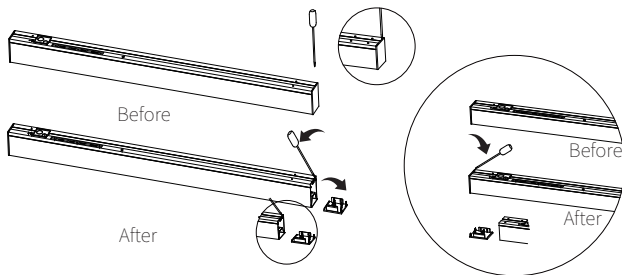

STEP 3 Slide in one end of the connector into the fixture.

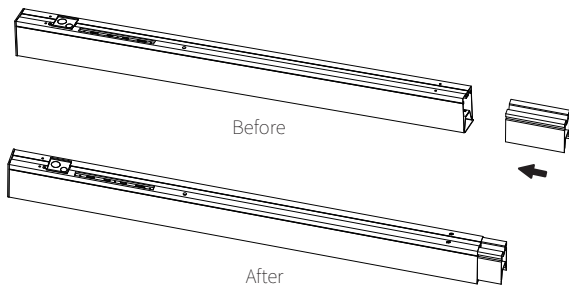

STEP 4 Feed the 3pin male/female power cable connector and 2pin male/female dimming wire connector through the linkable connector.

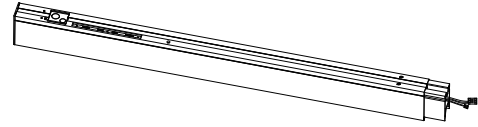

STEP 5 Take out the 3pin male/female power cable connector and 2pin male/female dimming wire connector from the linkable fixture, and plug the fast connectors, 3pin/3pin, 2pin/2pin. Then slide the linkable fixture into the connector and push forward till there's no gap between the fixtures.

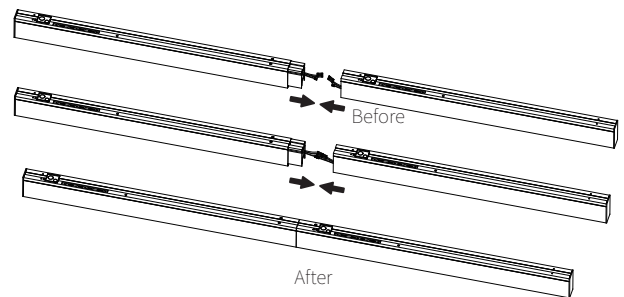

STEP 6 Fix the H mounting plate (provided) on the top with 4 screws(provided). The connection is done, turn on the power to verify your successful installation.

